

LOC		DIST		REVISIONS			
CM	0	REV	DATE	BY	CHK	APPV	
G		REVISED PER ECO-08-008919	15APR08	HMR		DB	

- MATERIAL: CONNECTOR- NYLON UL94V-2 (YELLOW).
 CONTACTS- 0.30 [.012] THK COPPER ALLOY
 (BRIGHT TIN-LEAD 0.00203 [.000080] MIN THK).
 (MATTE TIN 0.00203 [.000080] MIN THK).
- CONTACTS ACCEPT #20 AWG SOLID, FUSED STRANDED OR STRANDED (7 STRANDS) WIRE WITH 2.41 [.095] MAX INSULATION DIA.
- BOW, IN ANY DIRECTION, NOT TO EXCEED 0.15 [.006] PER IN.
- HOUSING FEATURES: FEED-THRU.
- DIMENSIONS IN BRACKETS ARE IN INCHES.

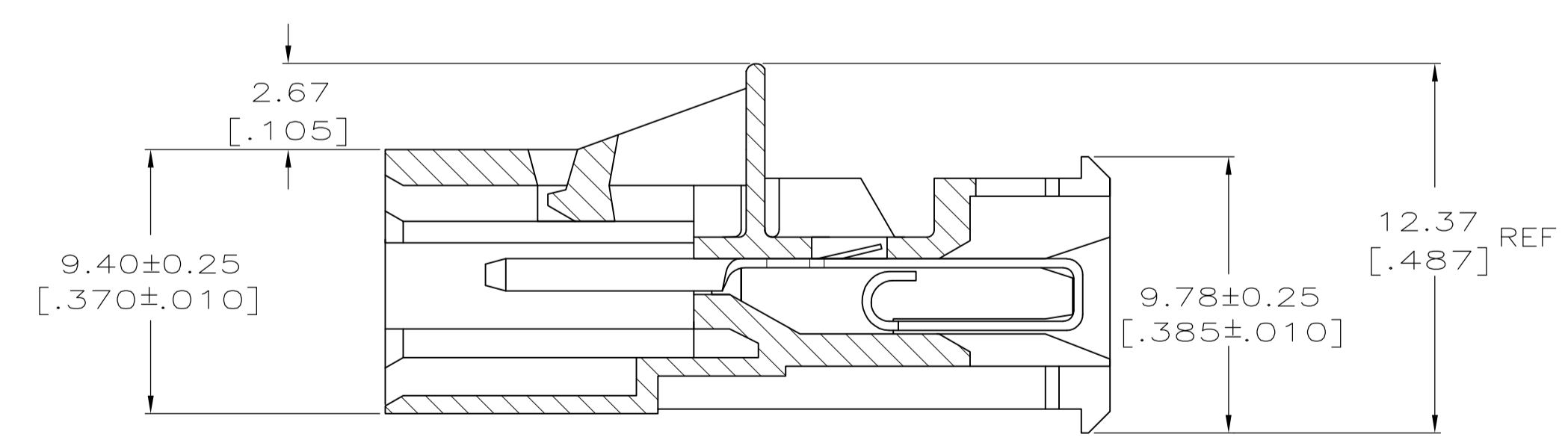
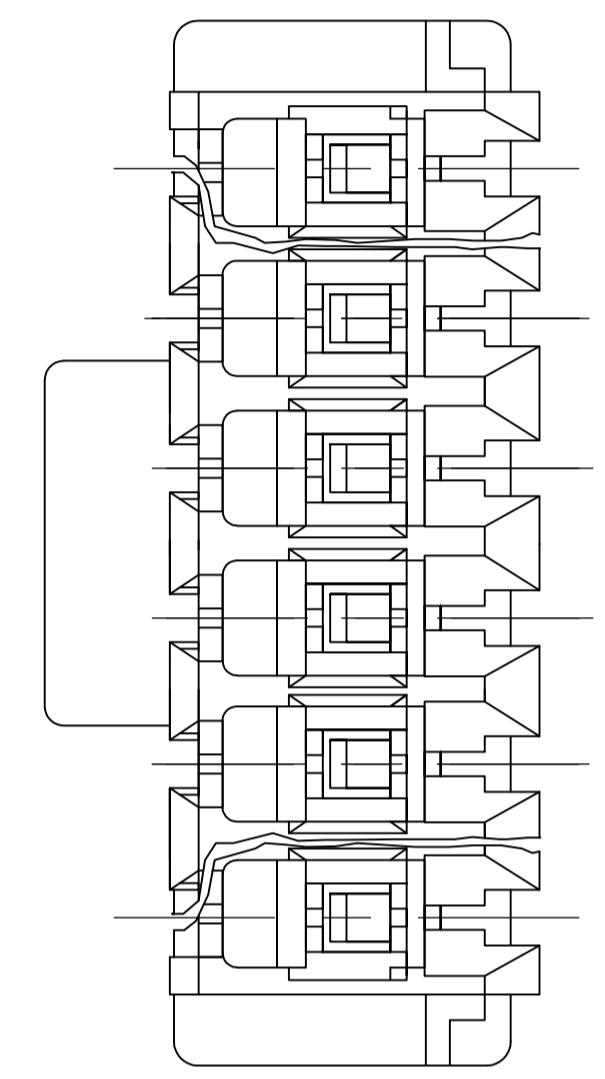
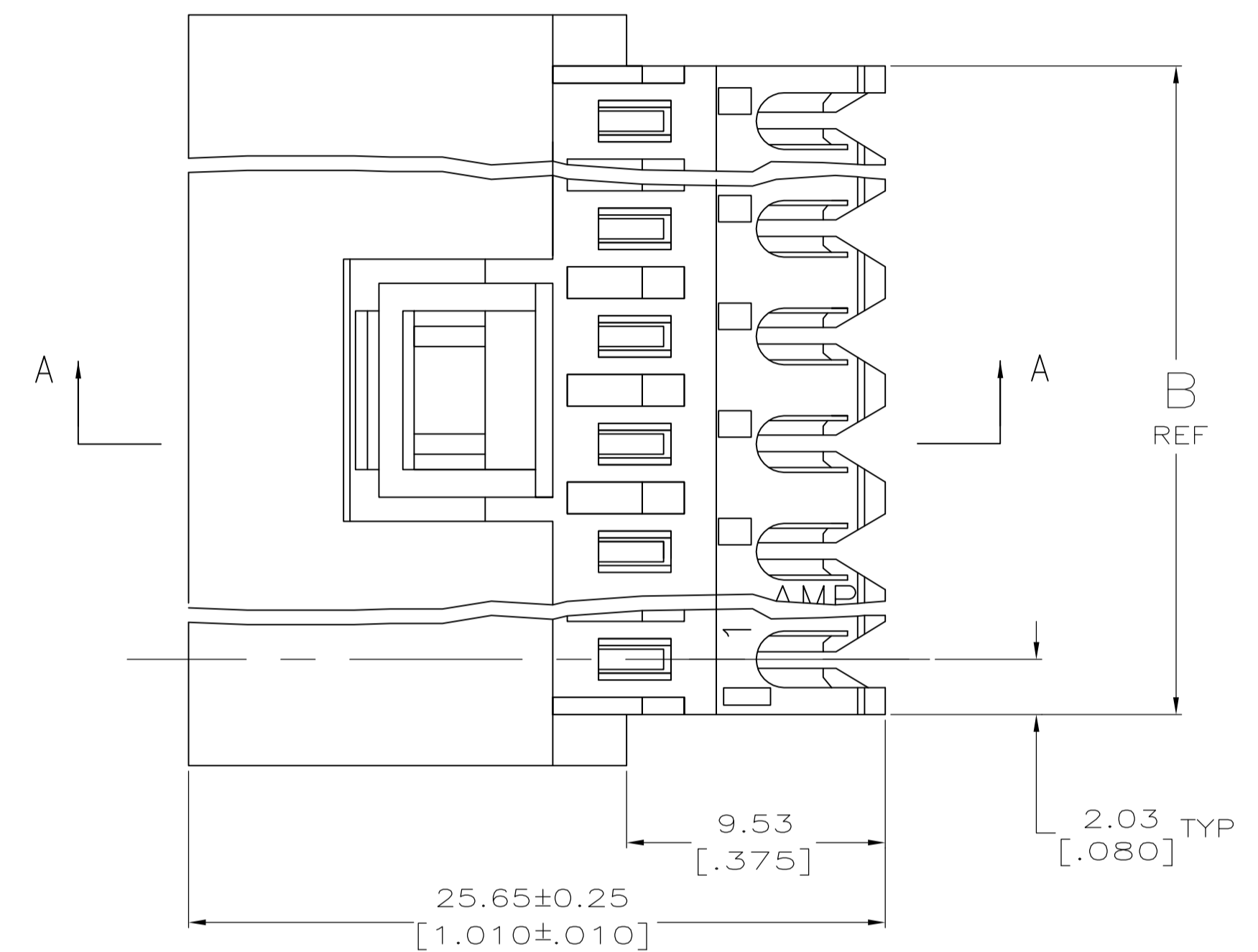
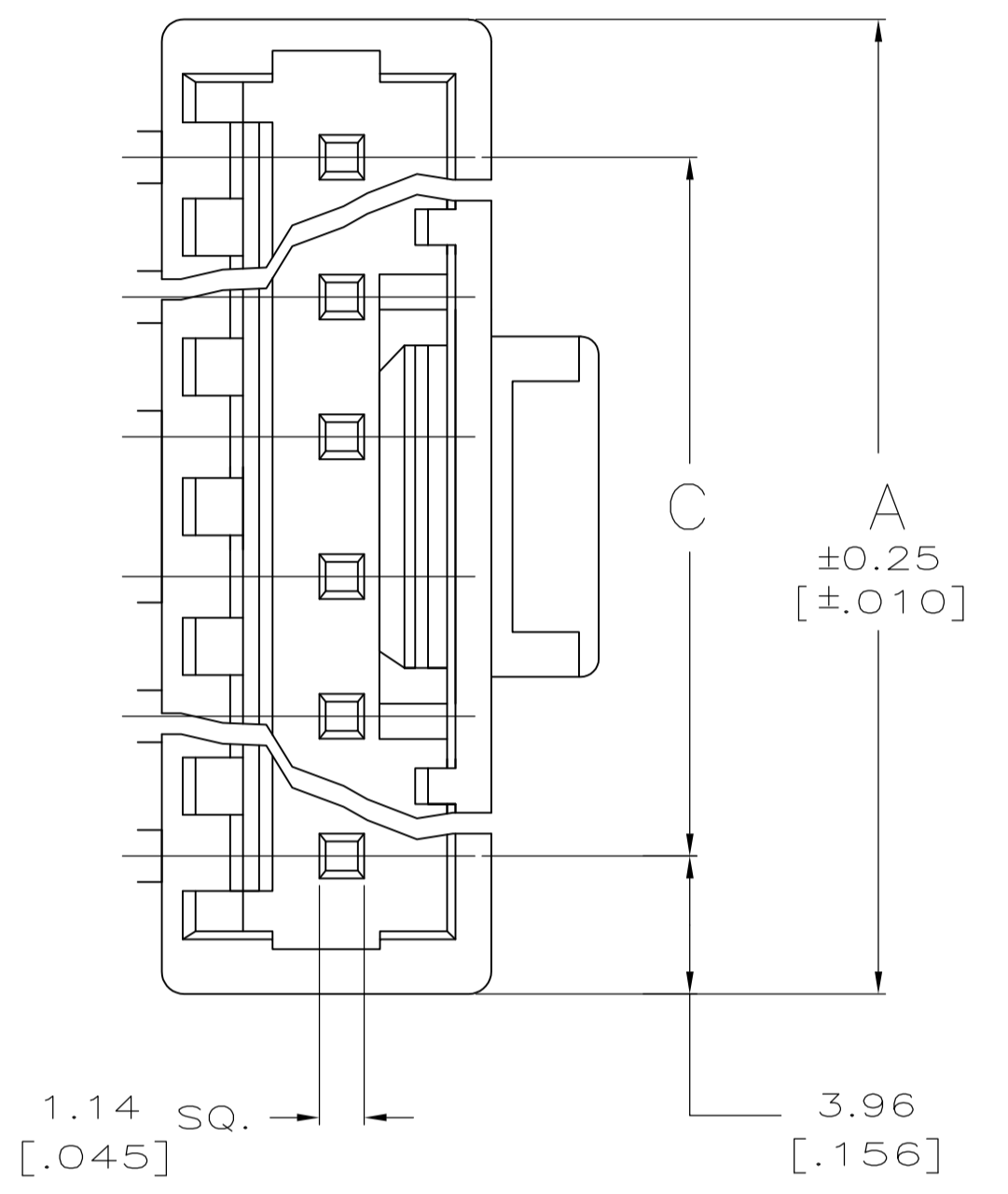

SECTION A-A

FINISH	C	B	A	NO. OF CIRCUITS	PART NUMBER	
TIN	91.14 [3.588]	95.20 [3.748]	99.06 [3.900]	24	5-641523-4	
	55.47 [2.184]	59.54 [2.344]	63.40 [2.496]	15	4-641523-5	
	43.59 [1.716]	47.65 [1.876]	51.51 [2.028]	12	4-641523-2	
	31.70 [1.248]	35.76 [1.408]	39.62 [1.560]	9	3-641523-9	
	19.81 [.780]	23.88 [.940]	27.74 [1.092]	6	3-641523-6	
	11.89 [.468]	15.95 [.628]	19.81 [.780]	4	3-641523-4	
	7.92 [.312]	11.99 [.472]	15.85 [.624]	3	3-641523-3	
	3.96 [.156]	8.03 [.316]	11.89 [.468]	2	3-641523-2	
	TIN-LEAD	91.14 [3.588]	95.20 [3.748]	99.06 [3.900]	24	2-641523-4
		55.47 [2.184]	59.54 [2.344]	63.40 [2.496]	15	1-641523-5
43.59 [1.716]		47.65 [1.876]	51.51 [2.028]	12	1-641523-2	
31.70 [1.248]		35.76 [1.408]	39.62 [1.560]	9	641523-9	
19.81 [.780]		23.88 [.940]	27.74 [1.092]	6	641523-6	
11.89 [.468]		15.95 [.628]	19.81 [.780]	4	641523-4	
7.92 [.312]		11.99 [.472]	15.85 [.624]	3	641523-3	
3.96 [.156]		8.03 [.316]	11.89 [.468]	2	641523-2	

THIS DRAWING IS A CONTROLLED DOCUMENT.

DIMENSIONS: mm [INCHES]

TOLERANCES UNLESS OTHERWISE SPECIFIED:

0 PLC	±	-
1 PLC	±	-
2 PLC	±	0.13 [.005]
3 PLC	±	-
4 PLC	±	-
ANGLES	±	-

MATERIAL: SEE NOTE 1

FINISH: SEE NOTE 1

WEIGHT: -

SIZE: A1

CAGE CODE: 00779

DRAWING NO: 641523

RESTRICTED TO: -

CUSTOMER DRAWING

SCALE: 5:1

SHEET: 1 OF 1

REV: G

THIS DRAWING IS A CONTROLLED DOCUMENT. DWN: K. SALMON 10-22-91. CHK: R. SWING 10-22-91. Tyco Electronics Corporation, Harrisburg, PA 17105-3608. Tyco Electronics Corporation, Harrisburg, PA 17105-3608. MTA-156 POSTED CONNECTOR ASSEMBLY, 20 AWG. SIZE: A1. CAGE CODE: 00779. DRAWING NO: 641523. RESTRICTED TO: -. CUSTOMER DRAWING. SCALE: 5:1. SHEET: 1 OF 1. REV: G.